

UNIT B  
GROUND FLOOR PLAN  
Scale 1:50

UNIT A  
GROUND FLOOR PLAN  
Scale 1:50

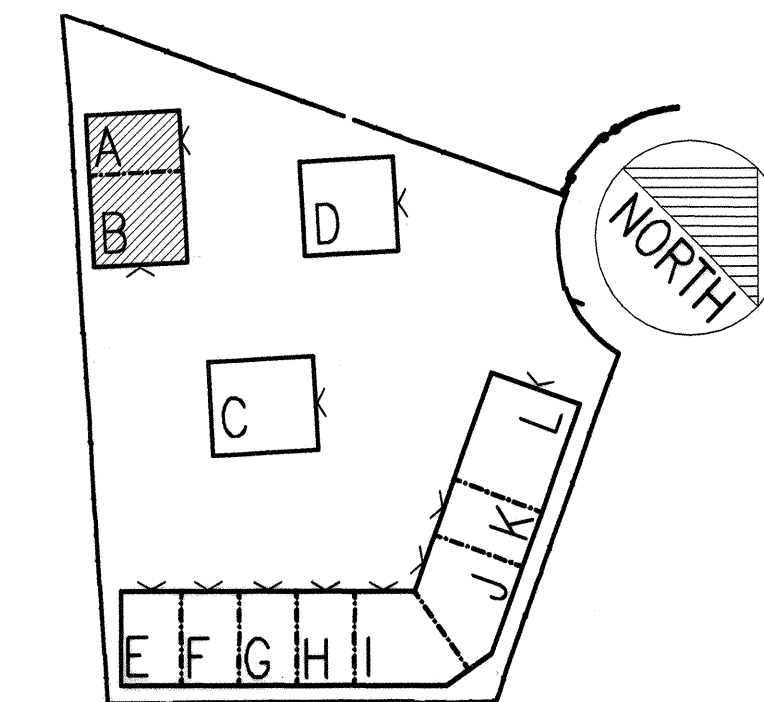

LOCATION PLAN  
Scale 1:1000

- REVISIONS
- C 30.09.2000 TJ  
DRAWINGS TRANSFERRED TO AUTOCAD  
UNIT J OMITTED.  
UNIT OPENING SIZES AMENDED.  
DIMENSIONS ADDED.  
WALLS DEVELOPED TO SHOW MASONRY CONSTRUCTION.
  - H 06.10.2000 TJ  
STAR DIMENSIONS AMENDED.  
INTERNAL PLASTER FINISH LAYER ADDED TO WALLS.
  - I 13.10.2000 TJ  
UNITS A + B FIRST FLOOR PLANS OMITTED.  
WINDOW AND EXTERNAL DOOR POSITIONS AND SIZES AMENDED.  
INTERNAL ROOM AND DOOR OPENING SIZES AMENDED.  
SECTION REFERENCE LINES ADDED.  
LOCATION PLAN ADDED.
  - J 24.10.2000 TJ  
INTERNAL WALL THICKNESS AMENDED.  
PIERS ADDED TO UNIT B MAIN ENTRANCE DOOR.  
DIMENSIONS AMENDED.  
SCALE OF LOCATION PLAN AMENDED.
  - K 24.11.2000 TJ  
DIMENSIONS AMENDED.  
WINDOW OPENING SIZES AMENDED.  
FINISHED FLOOR LEVELS ADDED.
  - L 29.12.2000 TJ  
RANWATER PIPE POSITIONS AMENDED.  
STORE WALL THICKNESS IN UNIT B REDUCED.  
THICKNESS OF WALL TO DISABLED TOILET/WC REDUCED.
  - M 27.02.2001 KO'C  
UNIT A: CORE DIMENSIONS REVISED.  
THICKNESS OF WALL TO DISABLED WC REDUCED.  
SINKS TO TEAPPOINTS REVISED.  
UNIT B: WALL THICKNESS TO STORE INCREASED TO 215MM, TEAPPOINT REVISED, SVP ADDED, PROTECTION TO RWP'S ADDED.
  - N 19.04.2001 KO'C  
UNIT B: DIMENSIONS REVISED AND ADDED. SUSPENDED CEILING TO TEAPPOINT INDICATED.

Date plotted: 19/04/01 12:39 PM

CLIENT  
REEDSPACE LIMITED

PROJECT  
12 OFFICE UNITS AT  
EASTERN ROAD BRACKNELL

DRAWING  
UNITS A + B  
GROUND FLOOR PLAN  
LOCATION PLAN

SCALE  
1:50

DRAWING NO. REVISION  
9901/05 N

DATE DRAWN BY  
SEPT 2000 TJ / KO'C

Do not scale drawing. Dimensions to be verified on site.  
This drawing is the property of Bill Reed Architecture and they reserve the copyright. The drawing is issued on the condition that it is not copied, reproduced, retained or disclosed to any unauthorised person, either wholly or in part, without the consent in writing of Bill Reed Architecture.

**BILL REED ARCHITECTURE**  
44 KINGS TERRACE, LONDON NW1 0UR. TELEPHONE 020 7387 4521 FAX 020 7387 2294